

SPECIFICATIONS

Current rating : 1A AC, DC
 Voltage rating : 50V AC, DC
 Temperature range : -25°C ~ +85°C
 Contact resistance : 20m ΩMax
 Insulation resistance : 100M ΩMin
 Withstanding voltage : 500 V AC/minute
 Pin Material : Phosphor Bronze
 Finished : Tin-plated
 Housing Material : Nylon-6T, UL94 V-0
 Color : Natural

Circuits	Dimension mm	
	A	B
2PIN	1.00	4.00
3PIN	2.00	5.00
4PIN	3.00	6.00
5PIN	4.00	7.00
6PIN	5.00	8.00
7PIN	6.00	9.00
8PIN	7.00	10.00
9PIN	8.00	11.00
10PIN	9.00	12.00
11PIN	10.00	13.00
12PIN	11.00	14.00
13PIN	12.00	15.00
14PIN	13.00	16.00
15PIN	14.00	17.00
16PIN	15.00	18.00
17PIN	16.00	19.00
18PIN	17.00	20.00
19PIN	18.00	21.00
20PIN	19.00	22.00

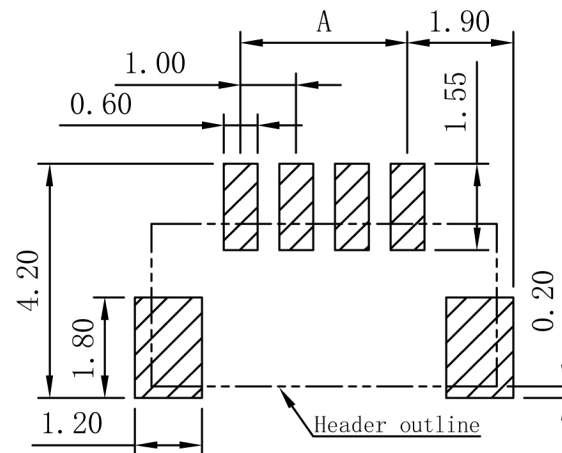
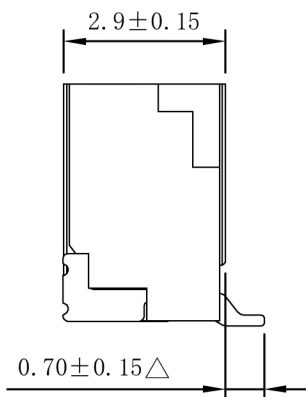
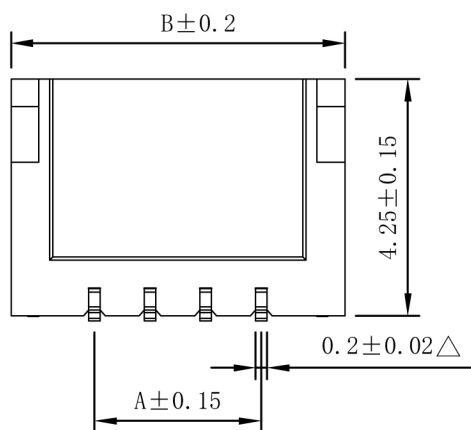

P. C. B Layout

DESCRIPTION(內容):	DRAWN(製圖):	GENERAL TOLERANCE:(公差)	REV: A/7	REV	DESCRIPTION	DATE
1.0mm Pin Wafer 180° SMT (環保材料)	袁仕潤	.0 ±0.20 .00 ±0.15 .000 ±0.10	UNIT:	1	Δ 此符號表示重點管控尺寸	2007.07.18
	CHECKED(確認):		mm	2	料號由 CSH-W10-XX 改為 CCSH-W10-XX	2007.10.10
PART NO: (料號) CCSH-W10-XX	APPROVAL(核准):	SCALE(比例): 1:XX	SIZE: A4	3	五金材質:磷青銅改為黃銅 五金材質:黃銅改為磷青銅	2008.04.11 2008.05.22
DWG NO(圖號):			SHEET: 1/1	4	修改Layout圖	2008.11.28 2009.06.15