

Specificatis

Current Rating : 2A AC, DC
 Voltage rating : 100V AC, DC
 Temperature range : -25°C ~ +85°C
 Contact resistance : 10mΩ Max
 Insulation resistance : 1000MΩ Min
 Withstanding voltage : 800 V AC/minute
 Pin Material : Brass
 Finished : Tin-plated
 Housing Material : Nylon-66, UL94 V-0
 Color : Ivory-white

PARTS NO.	Circuits	Dimension mm	
		A (mm)	B (mm)
CP-W20R-02	2	2.0	6.0
CP-W20R-03	3	4.0	8.0
CP-W20R-04	4	6.0	10.0
CP-W20R-05	5	8.0	12.0
CP-W20R-06	6	10.0	14.0
CP-W20R-07	7	12.0	16.0
CP-W20R-08	8	14.0	18.0
CP-W20R-09	9	16.0	20.0
CP-W20R-10	10	18.0	22.0
CP-W20R-11	11	20.0	24.0
CP-W20R-12	12	22.0	26.0
CP-W20R-13	13	24.0	28.0
CP-W20R-14	14	26.0	30.0
CP-W20R-15	15	28.0	32.0
CP-W20R-16	16	30.0	34.0
CP-W20R-17	17	32.0	36.0
CP-W20R-18	18	34.0	38.0

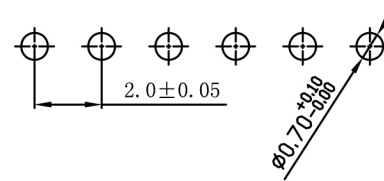
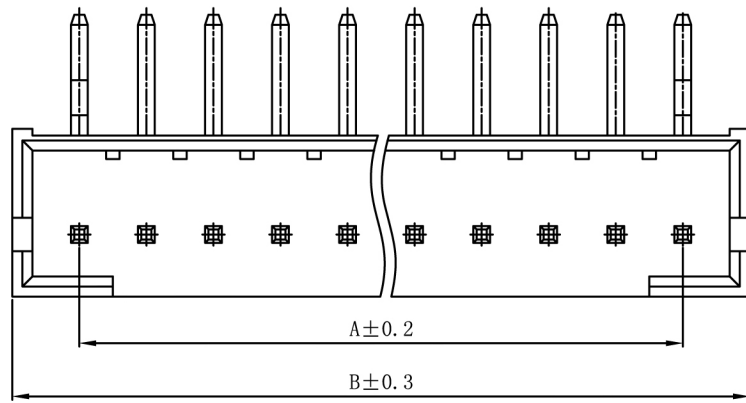

P. C. B. Hole Layout

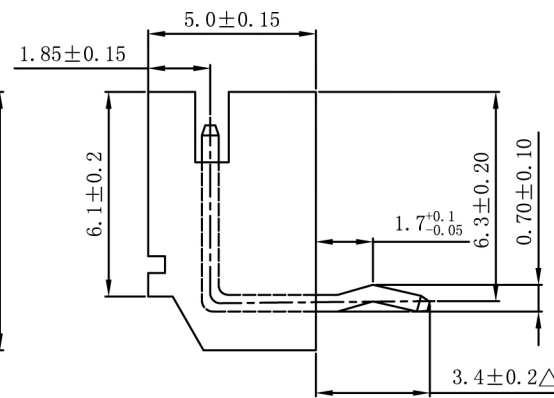
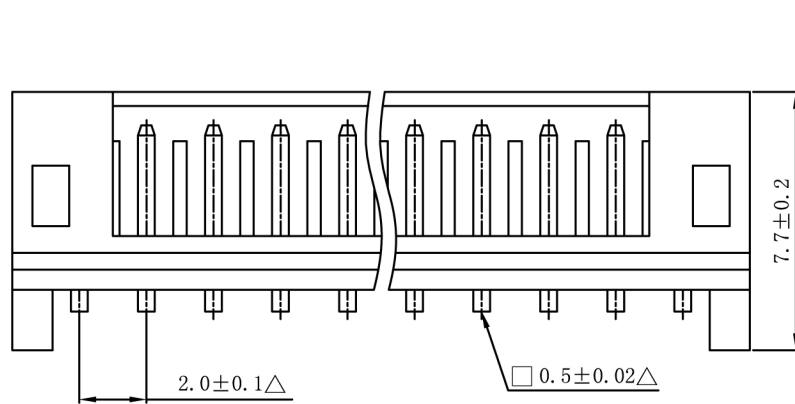

DESCRIPTION(內容):
2.0mm Wafer 90° □=0.50 打K
 (環保材料)

PART NO:
 (料號) **CP-W20R-XX**

DWG NO(圖號):

DRAWN(製圖):
 王建平

CHECKED(確認):

APPROVAL(核准):

GENERAL TOLERANCE:
 (公差)

.0 ±0.20
 .00 ±0.15
 .000 ±0.10

SCALE(比例):
 1:XX



REV:
 A/6

UNIT:
 mm

SIZE:
 A4

SHEET:
 1/1

REV

1

2

3

4

DESCRIPTION

△此符號表示重點管控尺寸

(1D)增加產品顏色標注

塑膠增大到18PIN

變更K度尺寸

DATE

2006.02.09

2007.07.04

2010.07.27

2011.12.26